



## STEEL HOOK K-15-R MOUNTING SYSTEM

### CHARACTERISTICS

Keno sp. z o.o. is pleased to present you with a solution for use on every pitched roof type covered with roof tiles. Thanks to its mobility, it allows the installation of all modules available on the market.

[SEE  
CATALOG](#)

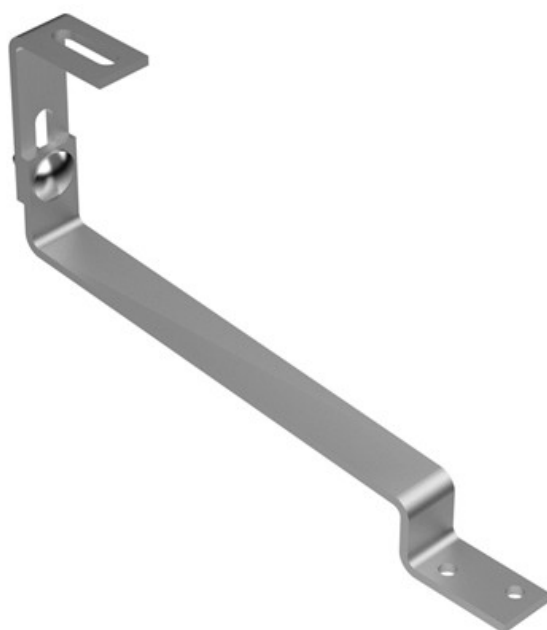

### CONSTRUCTION DESCRIPTION USING K-15-R HOOK

The hook has been manufactured with the greatest care and quality. Keno gives a 10-year guarantee on this construction, which can be extended to 15 years. We are able to offer you such a long guarantee because the hook is made of stainless steel. We have increased its service life by subjecting it to a shot-blasting treatment. This process not only extends the weather resistance of the hook, but also removes all burrs, so that the component is safe for our customer. The hook is assembled by fixing it to the roof rafters with a minimum of two screws. The hook includes an adjustment which allows the element to be adapted to the shape of the roof tile. The hook is compatible with all mounting profiles available from Keno. The assembly of the hook with the profile is performed using a "T" screw, which allows the hook to be installed at any point on the profile.

## STEEL HOOK K-15-R MOUNTING SYSTEM

### TECHNICAL DRAWING

The following figures present K-15-R hook from top position (fig1.), from bottom position (fig2.) and from top view (fig3.)

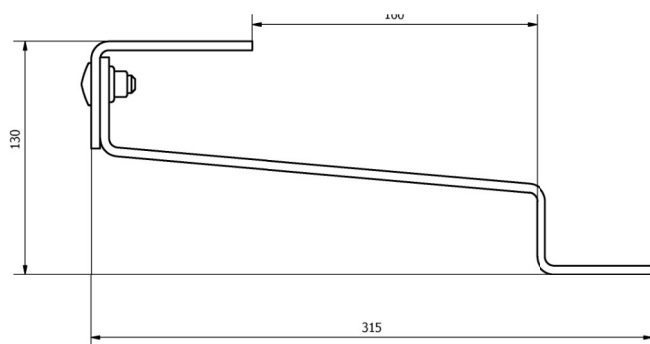

Fig1Top position

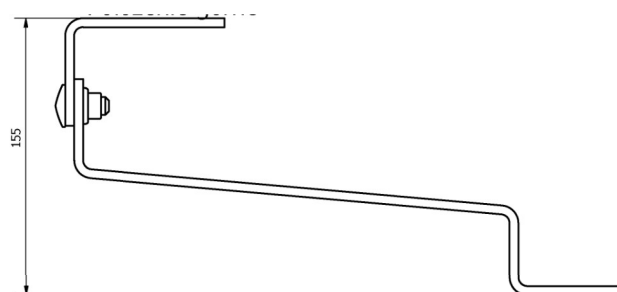

Fig 2 Bottom position

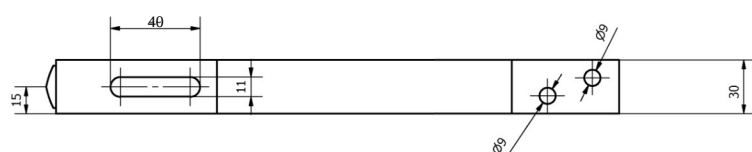

Fig 3 Top view